



October Newsletter 2022

2000th Trial Listing- Congratulations!

ClinTrial Refer (CTR) recently listed its 2000th trial in the database!

We would like to acknowledge and congratulate Jessica Aldcroft, ClinTrial Refer App Manager (pictured left), **NSW Oncology network**, and the team from the **Oncology Clinical Trials Unit at St George Private Hospital** for listing the **2000th trial!**

ClinTrial Refer has an amazing network of sites and App Managers that are committed to open access and transparency of current clinical trials. The App managers and sites in our community work hard to ensure clinical trial data in the CTR platform is current. These updates ensure clinical trial options are available to clinicians and patients and offer equitable access to potentially life changing clinical trial opportunities.

A big **THANK-YOU** to all our App Managers and sites for the fantastic work you do to ensure better access to current clinical trials for all!



Australian Researchers identify link between diet, gut microbiome and response to treatment



Researchers at **Melanoma Institute Australia** and **Charles Perkins Centre at The University of Sydney** have for the first time proven a link between a patient's diet and their likelihood of responding to immunotherapy.

Results showed those patients with microbiomes linked with high fibre consumption had a better response to immunotherapy given before surgery to remove their tumours.

Melanoma Institute Australia PhD student and study first author, Rebecca Simpson, said the findings were particularly important in terms of understanding the role of the gut microbiome during immunotherapy and efforts to target it to improve overall response to treatment.

'Australian patients had clear patterns in terms of response and immune-related adverse events based on a patient's diet, with poorer response to immunotherapy associated with lower fibre and omega-3 fatty acid consumption.'

The study involved prospectively profiling baseline gut (fecal) microbiota signatures and dietary patterns in 103 Australian and Dutch trial patients treated with neoadjuvant immunotherapy for high-risk resectable metastatic melanoma.

Melanoma Institute Australia Co-Medical Director and senior study author, Professor Georgina Long AO, said the results proved the need for further studies into the relationship between diet and response to immunotherapy treatments.

Get the full story and read more about this ground-breaking research [here](#).



You can view Melanoma Institute trials by visiting their [website](#) or download the **ClinTrial Refer MIA App** or visit [ClinTrial Refer website](#) to search for trials today.

Trial Spotlight



Trial Spotlight

On average 28 trials are listed in the ClinTrial Refer database every month

We aim to highlight some of these in our newsletter each month

Search CTR website 

Study of CPI-0610 in Myelofibrosis (MF) (MANIFEST-2)

Myelofibrosis is a serious, rare bone marrow disorder effecting the production of blood cells due to scarring in the bone marrow. This scarring causes other complications such as enlargement of the spleen and altered liver function. CPI-0610 is a new medication under investigation for treatment of myelofibrosis that has not yet been approved for use outside of this study. It is designed to target and kill cells which are not working normally in the bone marrow in myelofibrosis. The investigational medication is being evaluated to determine its effect on splenomegaly (enlarged spleen), bone marrow fibrosis and anaemia responses as well as quality of life.

The MANIFEST-2 study is a randomised, double-blind study comparing a new medication CPI-0610 combined with Ruxolitinib (Jakavi) versus a placebo combined with Ruxolitinib (Jakavi) in patients with myelofibrosis (MF). CPI-0610 is a medication that is a small molecule inhibitor of bromodomain and extra-terminal (BET) proteins. Evidence suggests that inhibition of both BET and JAK pathways can result in synergistic reduction of disease and overall improvement in the prognosis of MF. The study is currently recruiting 400 participants from 8 sites in New South Wales, Victoria, Queensland, Western Australia and South Australia and from other countries within APAC, USA, UK, Europe and Canada.

Key Inclusion Criteria:

1. Aged \geq 18 years
2. Confirmed diagnosis of myelofibrosis (primary, post-polycythemia vera, or post essential thrombocythemia)
3. Adequate hematologic, renal, and hepatic function

Key Exclusion Criteria:

1. Splenectomy or splenic irradiation in the previous 6 months
2. Had prior treatment with any JAKi or BET inhibitor for treatment of a myeloproliferative neoplasm

Specialist referral to a haematologist who is currently running this myelofibrosis research study is required. To find out more information about the study click [here](#).

ClinTrial Refer App Features- Selecting Favourite Apps

If there are Apps that you regularly refer to you can set them up as a favourite and add them to your 'My Favourite Apps' menu. Follow the steps below:

Setting a 'Favourite' App for the first time
Go to "My Favourite Apps" at the top of the main settings menu and click "Add Favourite App".

Select as many Favourite Apps as you like
Click "Continue"

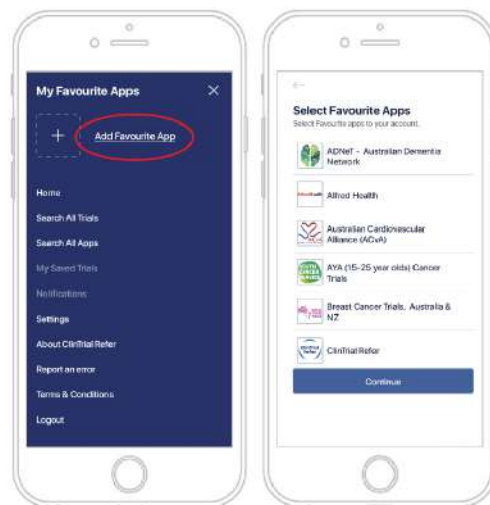

Adding Favourite Apps

If you want to add more 'Favourite' Apps Click on "Settings" in the main menu:

1. Go to "My Favourite Apps" and click "edit"
2. Click on "Manage My Favourite Apps"
4. Select as many Favourite Apps as you like.

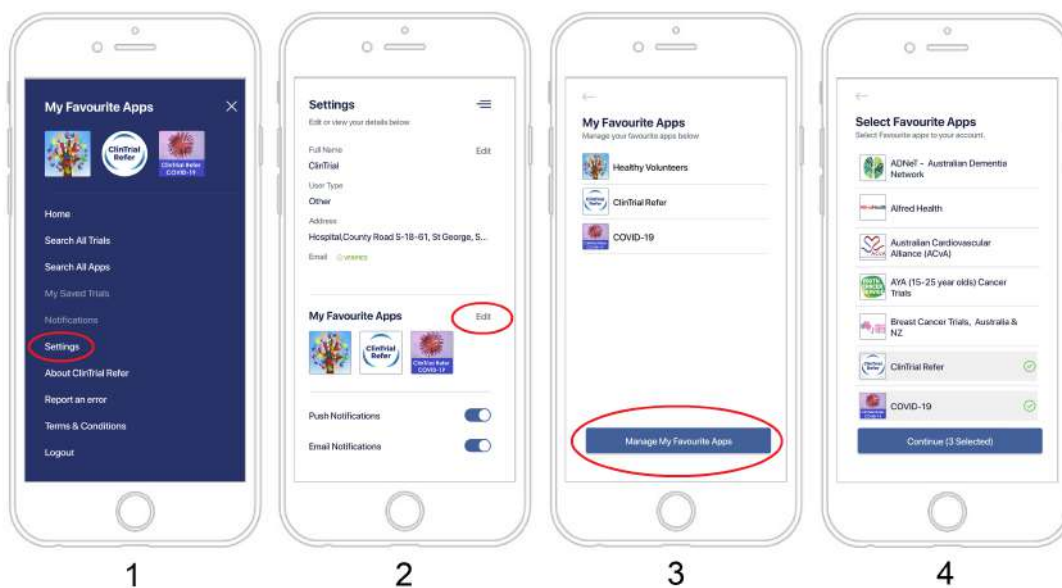

Breast Cancer Awareness Month

Breast Cancer Trials (BCT) is a group of world-leading breast cancer doctors and researchers based in Australia and New Zealand with a commitment to exploring and finding better treatments for people affected by breast cancer through clinical trials research.

As part of Breast Cancer Awareness Month, BCT are reflecting on how far clinical trials research has come since BCT first began in 1978, making advanced treatments, prevention strategies, and screening techniques available. However, there is still a lot more to be done, with breast cancer remaining the most commonly diagnosed cancer in the world.

BCT has a number of resources available to provide information and improve understanding of breast cancer in an effort to educate and inform the public, including the **2023 Australian Women's Health Diary**. This diary does more than help organise lives. It's packed with expert health advice for women of all ages and has raised close to \$18 million over the last 24 years in support of the BCT clinical trials research program. Grab your copy today from your local Newsagent, participating Post Office or to purchase online click [here](#).

Download the ClinTrial Refer App to view current **Breast Cancer Clinical Trials** or visit the [website](#) to search.

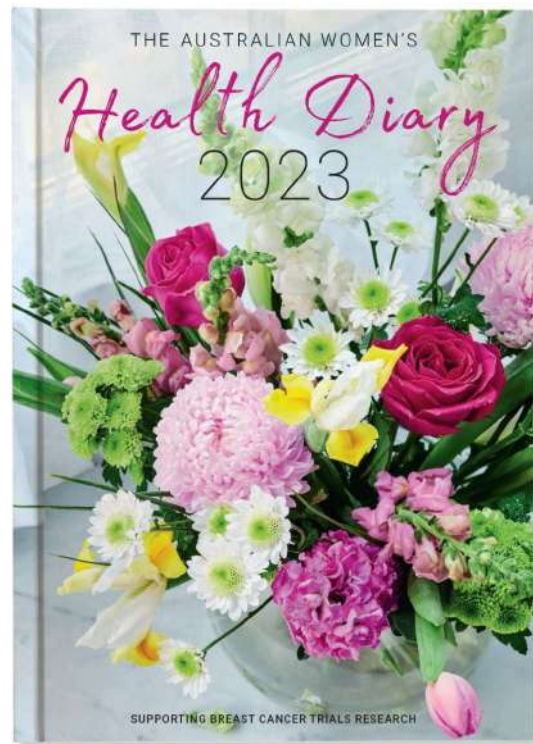

Do you have something to share?

Share your story if you have taken part in a clinical trial or supported someone through a trial. Your stories and thoughts are important to us and can be a great encouragement to others. If you'd like to share a clinical trial story please email us at admin@clintrialreferapp.com. We'd love to hear from you.



ADDRESS

ClinTrial Refer c/o Ground Floor,
W R Pitney Building, St George Hospital,
Gray Street, KOGARAH 2217
Australia

EMAIL

www.clintrialrefer.org.au/
admin@clintrialreferapp.com

[Unsubscribe](#)

Copyright © *2019* *ClinTrial Refer*, All rights reserved.

This email was sent to <<Email Address>>
[why did I get this?](#) [unsubscribe from this list](#) [update subscription preferences](#)
ClinTrialRefer · St George Hospital · Gray Street · Kogarah, Nsw 2017 · Australia